

BLIND 150

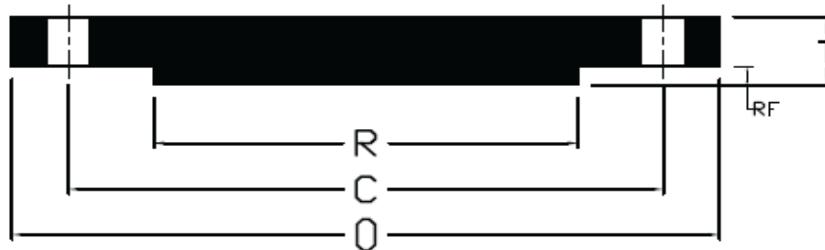

ANSI B16.5 CLASS 150 BLIND FLANGES

Nominal Pipe Size	Outside Diameter (O)	Thickness (T)	Raised Face Diameter (R)	Number of Holes	Diameter of Holes	Bolt Circle (C)	Approximate Weight (lbs)
½	3.50	0.38	1.38	4	0.62	2.38	2
¾	3.88	0.44	1.69	4	0.62	2.75	2
1	4.25	0.50	2.00	4	0.62	3.12	2
1¼	4.62	0.56	2.50	4	0.62	3.50	3
1½	5.00	0.62	2.88	4	0.62	3.88	4
2	6.00	0.69	3.62	4	0.75	4.75	5
2½	7.00	0.81	4.12	4	0.75	5.50	7
3	7.50	0.88	5.00	4	0.75	6.00	9
3½	8.50	0.88	5.50	8	0.75	7.00	13
4	9.00	0.88	6.19	8	0.75	7.50	17
5	10.00	0.88	7.13	8	0.88	8.50	20
6	11.00	0.94	8.50	8	0.88	9.50	27
8	13.50	1.06	10.62	8	0.88	11.75	47
10	16.00	1.12	12.75	12	1.00	14.25	70
12	19.00	1.19	15.00	12	1.00	17.00	123
14	21.00	1.31	16.25	12	1.12	18.75	140
16	23.50	1.38	18.50	16	1.12	21.25	180
18	25.00	1.50	21.00	16	1.25	22.75	220
20	27.50	1.62	23.00	20	1.25	25.00	285
22	29.50	1.75	25.25	20	1.38	27.25	355
24	32.00	1.81	27.25	20	1.38	29.50	430

*All Dimensions are in inch

*These flanges will be furnished with a 1/16" raised face unless otherwise specified.

*Flat face option available.



PHONE: 866 6350600/6341284/6342619/6342620 WWW.PERFITUBOS.COM

BLIND 300

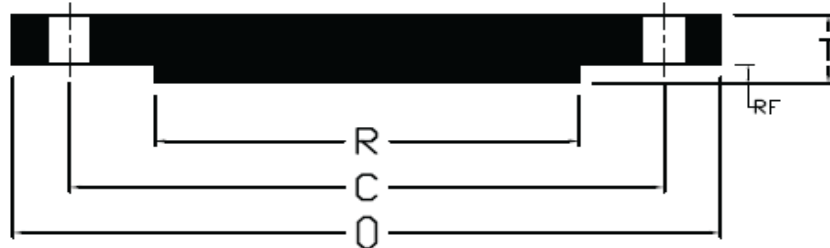

ANSI B16.5 CLASS 300 BLIND FLANGES

Nominal Pipe Size	Outside Diameter (O)	Thickness (T)	Raised Face Diameter (R)	Number of Holes	Diameter of Holes	Bolt Circle (C)	Approximate Weight (lbs)
½	3.75	0.50	1.38	4	0.63	2.62	2
¾	4.62	0.56	1.69	4	0.75	3.25	3
1	4.88	0.62	2.00	4	0.75	3.50	4
1¼	5.25	0.69	2.50	4	0.75	3.88	6
1½	6.12	0.75	2.88	4	0.88	4.50	7
2	6.50	0.81	3.62	8	0.75	5.00	8
2½	7.50	0.94	4.12	8	0.88	5.88	12
3	8.25	1.06	5.00	8	0.88	6.62	16
3½	9.00	1.12	5.50	8	0.88	7.25	21
4	10.00	1.19	6.19	8	0.88	7.88	28
5	11.00	1.31	7.31	8	0.88	9.25	37
6	12.50	1.38	8.50	12	0.88	10.62	50
8	15.00	1.56	10.62	12	1.00	13.00	81
10	17.50	1.81	12.75	16	1.12	15.25	124
12	20.50	1.94	15.00	16	1.25	17.75	185
14	23.00	2.06	16.25	20	1.25	20.25	250
16	25.50	2.19	18.50	20	1.38	22.50	315
18	28.00	2.31	21.00	24	1.38	24.75	414
20	30.50	2.44	23.00	24	1.38	27.00	515
22	33.00	2.57	25.25	24	1.63	29.25	640
24	36.00	2.69	27.25	24	1.63	32.00	800

*All Dimensions are in inch

*These flanges will be furnished with a 1/16" raised face unless otherwise specified.

*Flat face option available.



PHONE: 866 6350600/6341284/6342619/6342620 WWW.PERFITUBOS.COM

BLIND 600

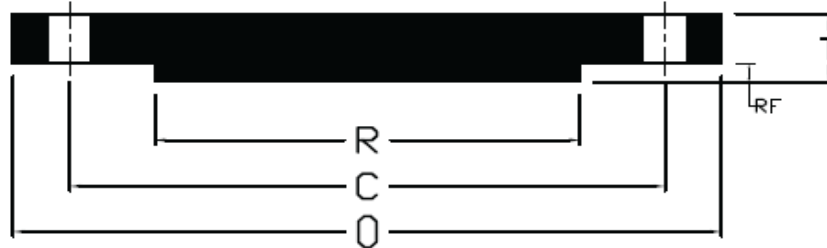

ANSI B16.5 CLASS 600 BLIND FLANGES

Nominal Pipe Size	Outside Diameter (O)	Thickness (T)	Raised Face Diameter (R)	Number of Holes	Diameter of Holes	Bolt Circle (C)	Approximate Weight (lbs)
½	3.75	0.56	1.38	4	0.63	2.62	3
¾	4.62	0.62	1.69	4	0.75	3.25	4
1	4.88	0.69	2.00	4	0.75	3.50	4
1¼	5.25	0.81	2.50	4	0.75	3.88	6
1½	6.12	0.88	2.88	4	0.88	4.50	8
2	6.50	1.00	3.62	8	0.75	5.00	10
2½	7.50	1.12	4.12	8	0.88	5.88	15
3	8.25	1.25	5.00	8	0.88	6.62	20
3½	9.00	1.38	5.50	8	1.00	7.25	29
4	10.75	1.50	6.19	8	1.00	8.50	41
5	13.00	1.75	7.31	8	1.12	10.50	68
6	14.00	1.88	8.50	12	1.12	11.50	86
8	16.50	2.19	10.62	12	1.25	13.75	140
10	20.00	2.50	12.75	16	1.38	17.00	231
12	22.00	2.62	15.00	20	1.38	19.25	295
14	23.75	2.75	16.25	20	1.50	20.75	378
16	27.00	3.00	18.50	20	1.63	23.75	527
18	29.25	3.25	21.00	20	1.75	25.75	665
20	32.00	3.50	23.00	24	1.75	28.50	855
22	34.25	3.75	25.25	24	1.75	30.63	1000
24	37.00	4.00	27.25	24	2.00	33.00	1250

*All Dimensions are in inch

*These flanges will be furnished with a 1/4" raised face unless otherwise specified.

*Flat face option available.



PHONE: 866 6350600/6341284/6342619/6342620 WWW.PERFITUBOS.COM

BLIND 900

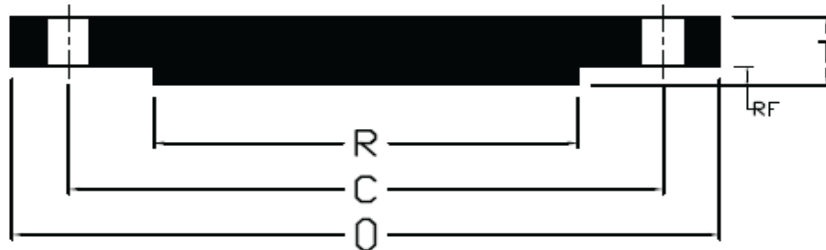

ANSI B16.5 CLASS 900 BLIND FLANGES

Nominal Pipe Size	Outside Diameter (O)	Thickness (T)	Raised Face Diameter (R)	Number of Holes	Diameter of Holes	Bolt Circle (C)	Approximate Weight (lbs)
½	4.75	0.88	1.38	4	0.88	3.25	4
¾	5.12	1.00	1.69	4	0.88	3.50	6
1	5.88	1.12	2.00	4	1.00	4.00	9
1¼	6.25	1.12	2.50	4	1.00	4.38	10
1½	7.00	1.25	2.88	4	1.12	4.88	14
2	8.50	1.50	3.63	8	1.00	6.50	25
2½	9.62	1.62	4.13	8	1.12	7.50	32
3	9.50	1.50	5.00	8	1.00	7.50	35
4	11.50	1.75	6.19	8	1.25	9.25	54
5	13.75	2.00	7.31	8	1.38	11.00	87
6	15.00	2.19	8.50	12	1.25	12.50	115
8	18.50	2.50	10.63	12	1.50	15.50	200
10	21.50	2.75	12.75	16	1.50	18.50	290
12	24.00	3.12	15.00	20	1.50	21.00	415
14	25.25	3.38	16.25	20	1.63	22.00	520
16	27.75	3.50	18.50	20	1.75	24.25	619
18	31.00	4.00	21.00	20	2.00	27.00	880
20	33.75	4.25	23.00	20	2.13	29.50	1107
24	41.00	5.50	27.25	20	2.63	35.50	2099

*All Dimensions are in inch

*These flanges will be furnished with a 1/4" raised face unless otherwise specified.

*Flat face option available.



PHONE: 866 6350600/6341284/6342619/6342620 WWW.PERFITUBOS.COM

BLIND 1500

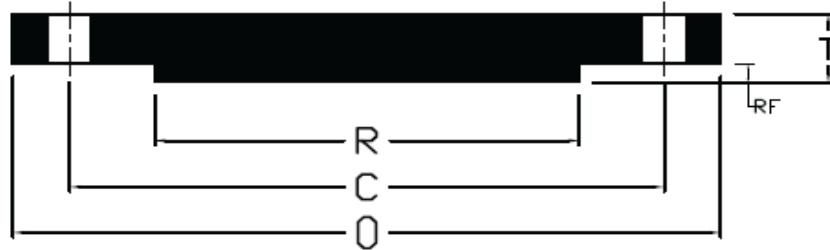

ANSI B16.5 CLASS 1500 BLIND FLANGES

Nominal Pipe Size	Outside Diameter (O)	Thickness (T)	Raised Face Diameter (R)	Number of Holes	Diameter of Holes	Bolt Circle (C)	Approximate Weight (lbs)
½	4.75	0.88	1.38	4	0.88	3.25	4
¾	5.12	1.00	1.69	4	0.88	3.50	6
1	5.88	1.12	2.00	4	1.00	4.00	9
1¼	6.25	1.12	2.50	4	1.00	4.38	10
1½	7.00	1.25	2.88	4	1.12	4.88	14
2	8.50	1.50	3.63	8	1.00	6.50	25
2½	9.62	1.62	4.13	8	1.12	7.50	35
3	10.50	1.88	5.00	8	1.25	8.00	48
4	12.25	2.12	6.19	8	1.38	9.50	73
5	14.75	2.88	7.13	8	1.63	11.50	140
6	15.50	3.25	8.50	12	1.50	12.50	160
8	19.00	3.62	10.63	12	1.75	15.50	302
10	23.00	4.25	12.75	12	2.00	19.00	510
12	26.50	4.88	15.00	16	2.12	22.50	775
14	29.50	5.25	16.25	16	2.38	25.00	975
16	32.50	5.75	18.50	16	2.63	27.75	1300
18	36.00	6.38	21.00	16	2.88	30.50	1750
20	38.75	7.00	23.00	16	3.12	32.75	2225
24	46.00	8.00	27.25	16	3.63	39.00	3625

*All Dimensions are in inch

*These flanges will be furnished with a 1/4" raised face unless otherwise specified.

*Flat face option available.



PHONE: 866 6350600/6341284/6342619/6342620 WWW.PERFITUBOS.COM